

# 3.5 CARBURETOR IN RED, BLACK, GOLD

ALSO USED ON EARLY 6.5 & 7.5  
NECK DIAMETER .437"

BLACK THROAT DIA .265" = 80-8904  
RED THROAT DIA .345" = 80-8903  
GOLD THROAT DIA .312" = 80-8902

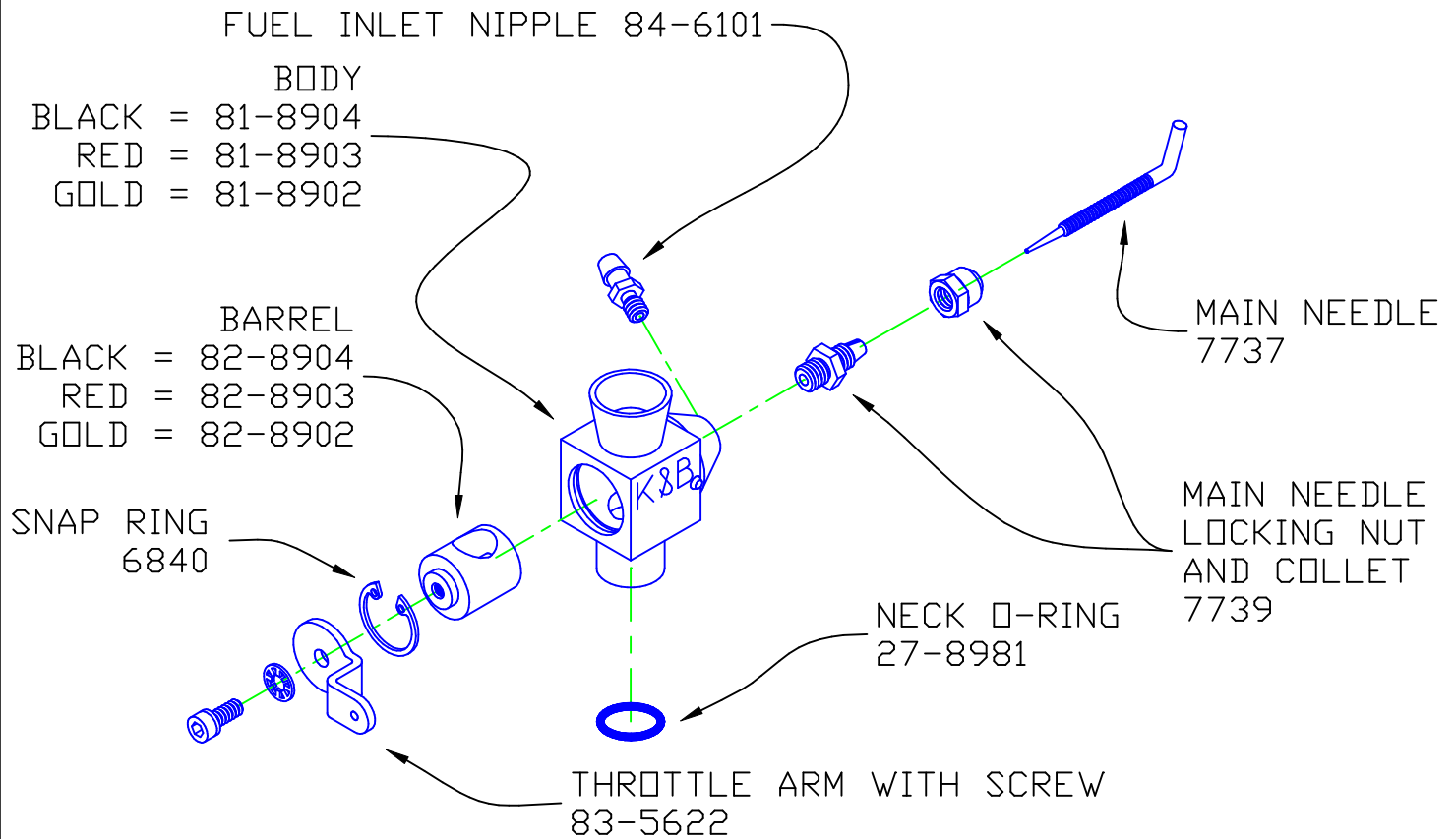

LATE MODEL USES SNAP RING TO RETAIN BARREL

BLACK THROAT DIA .265" = 80-8906  
RED THROAT DIA .345" = 80-8905  
GOLD THROAT DIA .312" = 80-8901

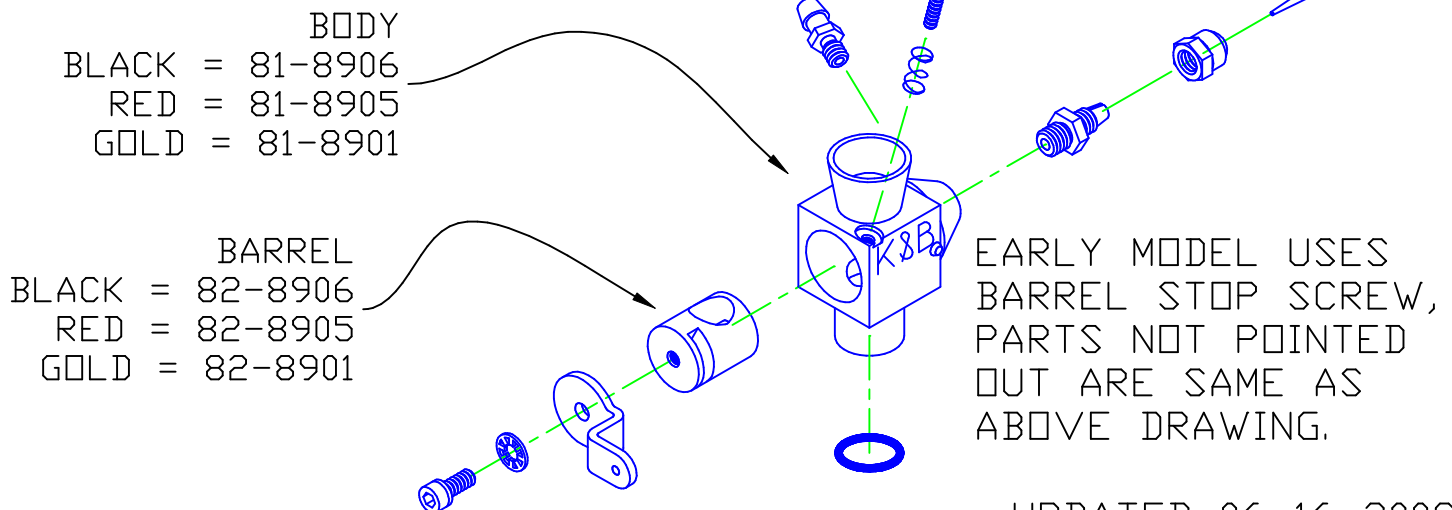

UPDATED 06-16-2009